



**Shouh Mao Industrial Co., Ltd**

No.240, Wandung Rd., Hsutan Shiang, Changhua Hsien, 503 Taiwan R.O.C  
E. sm460420@ms27.hinet.net T. 886-4-7878318 F. 886-4-7876506-7  
www.shouhmao.com.tw



All of our products are all insured against  
**Product Liability Insurance.**

## MADE IN TAIWAN CATALOG

About SHOUH MAO	1
POP BIKE	2~3
Heavy Load Training Wheels	4~7
Flip-up Training Wheels	8
For multi-speed bike Training Wheels	9
Training Wheels	10~23

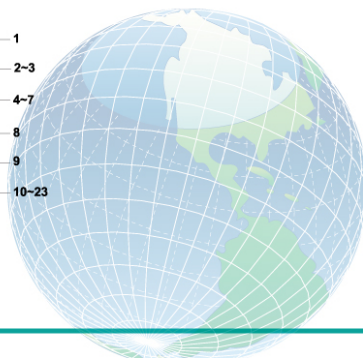

## Introduction

SHOUH MAO INDUSTRIAL CO.,LTD.

Shouh Mao was founded in 1981. We specialized in developing and manufacturing in bicycle parts and accessories more than 35 years. We sell our products over 35 countries and maintain good reputation among our clients. Many of manufactures have moved to China in the past few years, but we still decided to stay in our hometown Taiwan. We keep on providing the highest quality to our customers as well as the most competitive prices.

In the beginning of 2003, our factory moved to mid region of Taiwan and purchased more automatic machineries. We also promote our brand "X-PRIT" in global markets. Shouh Mao has an excellent R&D group that are constantly researching and developing new product to serve our customers worldwide.



EVA Tire

EVA Tire

EVA Tire

Box Packaging

POPBIKE

Item No.: SM-300  
 Height: 55 cm  
 Length: 77 cm  
 Highest seat from the ground: 95cm  
 Weight:  
 Pop bike with Pneumatic Tire: 3.2 KGS  
 Pop bike with EVA Tire: 2.8 KGS  
 Material:  
 Frame: Composite plastic  
 Fork: Composite plastic  
 Wheel: PPR rim / Pneumatic Tire or EVA Tire  
 Grip: TPR  
 Seat: ABS+TPR

Pop Bike with Brake  
 煞車版 - 可安裝於前叉

SM-3003 Carry Bag  
 機車袋

SM-3007 Protection Gears  
 護具組

SM-3004 Seat Cover  
 椅座套

SM-3005 Helmet  
 安全帽

SM-3002 Extension Seat Sock  
 增高座

SM-3001 Trained Wheel  
 駐車輪

SM-3001 Pop Bike Trailer  
 拖車

# Safety Guardian

Multifunction and High Load Training Wheel.  
Fit most 20"-29" single or multi-speed bike models.  
**Maximum load weight is 120 KGS.**  
Suitable for trainee, inexperienced adult & elderly riders.  
Simple fitting instructions included.  
Not suitable for electric or any motorised bikes.

Suitable for:

1. Riders who need medical rehabilitation.
2. Riders who lack a sense of balance.
3. Riders who miss the golden learning time.
4. Elderly riders use in exercise or daily transportation.
5. Riders who wish to exercise at home.
6. Riders who want to train at home.

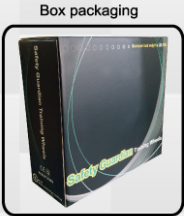

SM-905

Features:

- Multifunction and High Load Training Wheel.
- Fit 20" - 29" all kind series bike.
- **Maximum load weight is 120 KGS.**

Specification:

- For 20" to 29" bike.
- Bracket: 5m/m Steel plate.
- Wheel: 12" P.P BK / Aluminum Alloy RIM (Bearing axle) with Pneumatic Tire.



SM-906



ABS+TPR

SM-9520



Heavy Load Training Wheels  
SM-901-QW  
Bike size: 20"- 26" bicycles.  
Stay size: 5m/m steel plate stay.  
Wheel size: 6"  
Rim: Bearing & Plastic  
Tire: Rubber tire.



Heavy Load Training Wheels  
SM-902-QW  
Bike size: 16"- 24" bicycles.  
Stay size: 5m/m steel plate stay.  
Wheel size: 5"  
Rim: Bearing & Plastic  
Tire: Rubber tire.



Heavy Load Training Wheels  
SM-903-QW  
Bike size: 20"- 26" bicycles.  
Stay size: 5m/m steel plate stay.  
Wheel size: 6"  
Rim: Bearing & Plastic  
Tire: Rubber tire.



Heavy Load Training Wheels  
SM-901-RW  
Bike size: 24"- 28" bicycles.  
Stay size: 5m/m steel plate stay.  
Wheel size: 6"  
Rim: Bearing & Plastic  
Tire: Rubber tire.



Heavy Load Training Wheels  
SM-902-RW  
Bike size: 20"- 26" bicycles.  
Stay size: 5m/m steel plate stay.  
Wheel size: 5"  
Rim: Bearing & Plastic  
Tire: Rubber tire.



Heavy Load Training Wheels  
SM-903-RW  
Bike size: 24"- 28" bicycles.  
Stay size: 5m/m steel plate stay.  
Wheel size: 6"  
Rim: Bearing & Plastic  
Tire: Rubber tire.

VX



SM-801VX-LED  
12"- 20"



SM-283-VX  
12"- 20"



SM-284-VX  
12"- 20"



SM-287-VX  
12"- 20"

UX

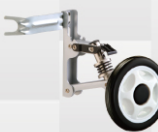

SM-701-UX  
12"- 16"



SM-703-UX  
12"- 16"

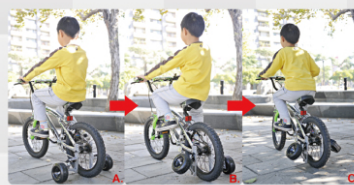

Bike Size: 12"- 16" • 12"- 20" bicycle.  
Material: 3m/m-3.5m/m steel plate stay.  
Wheel Size: 5" Plastic rim.  
Tire: EVA tire & TPR tire.



SM-283-W



SM-284-W



SM-287-W



SM-701-W



SM-703-W

Bike size: 16"- 24" single speed and multi-speed bicycles.  
Stay size: 3.5m/m - 4m/m Heavy steel plate stay.  
(It is fixed by screw)  
Wheel size: 4-1/2" ~ 5"  
Tire: EVA tire & TPR tire.  
Recommended maximum weight limit 40 kgs.

W



Q



SM-801Q-LED  
12"- 20"



SM-216-Q  
12"- 20"



SM-283-Q  
12"- 20"



SM-284-Q  
12"- 20"



SM-287-Q  
12"- 20"



SM-540-Q  
12"- 20"



SM-703-Q  
12"- 20"

Bike Size: 12" - 20" bicycles.  
Material: 5m/m steel plate stay.  
Wheel Size: 4-1/2", 5" plastic rim.  
Tire: EVA tire & TPR tire.



SM-216-O  
12"- 20"



SM-283-O  
12"- 20"



SM-284-O  
12"- 20"



SM-287-O  
12"- 20"



SM-540-O  
12"- 20"



SM-703-O  
12"- 20"

Bike Size: 12" - 20" bicycles.  
Material: 3m/m-3.5m/m steel plate stay.  
Wheel Size: 4-1/2", 5" plastic rim.  
Tire: EVA tire & TPR tire.

O

N



SM-801N-LED  
12"- 20"



SM-216-N  
12"- 20"



SM-283-N  
12"- 20"



SM-284-N  
12"- 20"



SM-540-N  
12"- 20"



SM-287-N  
12"- 20"



SM-703-N  
12"- 20"

Bike Size: 12"- 20" bicycles.  
Material: 3m/m-3.5m/m steel plate stay.  
Wheel Size: 4-1/2", 5" plastic rim.  
Tire: EVA tire & TPR tire.



SM-801M-LED  
12"- 20"



SM-216-M  
12"- 20"



SM-283-M  
12"- 20"



SM-284-M  
12"- 20"

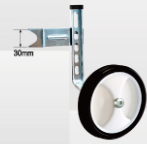

SM-287-M  
12"- 20"



SM-540-M  
12"- 20"



SM-703-M  
12"- 20"

Bike Size: 12"- 20" bicycles.  
Material: 3m/m-3.5m/m steel plate stay.  
Wheel Size: 4-1/2", 5" plastic rim.  
Tire: EVA tire & TPR tire.

M





SM-801AF-LED  
12"-20"



SM-216-AF  
12"-20"



SM-283-AF  
12"-20"



SM-284-AF  
12"-20"



SM-287-AF  
12"-20"

SM-540-AF  
12"-20"

SM-703-AF  
12"-20"

Bike Size: 12"- 20" bicycles.  
Material: 3m/m-3.5m/m steel plate stay.  
Wheel Size: 4-1/2", 5" plastic rim.  
Tire: EVA tire & TPR tire.



SM-216-YE



SM-283-YE



SM-284-YE



SM-285-YE



SM-287-YE



SM-540-YE



SM-703-YE

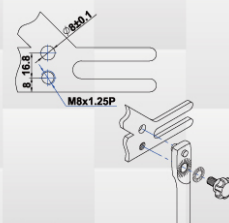

**Bike Size:**  
12" • 14" • 16" • 18" • 20" bicycles.  
**Material:** 13m/m steel plate stay.  
**Wheel Size:** 4-1/2", 5" plastic rim.  
**Tire:** EVA tire & TPR tire.

V



SM-801V-LED  
16"-20"



SM-216-V  
16"-20"



SM-283-V  
16"-20"



SM-284-V  
16"-20"



SM-287-V  
16"-20"



SM-540-V  
16"-20"



SM-703-V  
16"-20"

Bike Size: 16"- 20" bicycles.  
Material: 3m/m-3.5m/m steel plate stay.  
Wheel Size: 4-1/2", 5" plastic rim.  
Tire: EVA tire & TPR tire.



SM-801U-LED  
12"-16"



SM-216-U  
12"-16"



SM-283-U  
12"-16"



SM-284-U  
12"-16"



SM-287-U  
12"-16"



SM-540-U  
12"-16"



SM-703-U  
12"-16"

Bike Size: 12"- 16" bicycles.  
Material: 3m/m-3.5m/m steel plate stay.  
Wheel Size: 4-1/2", 5" plastic rim.  
Tire: EVA tire & TPR tire.

U

P



SM-216-P



SM-283-P



SM-284-P



SM-287-P



SM-540-P



SM-703-P

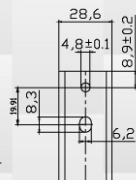

Bike Size: 12" - 14" - 16" - 18" - 20" bicycles.  
Material: 3m/m-3.5m/m steel plate stay.  
Wheel Size: 4-1/2", 5" plastic rim.  
Tire: EVA tire & TPR tire.

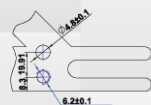

SM-216-S



SM-283-S



SM-284-S



SM-287-S



SM-540-S



SM-703-S

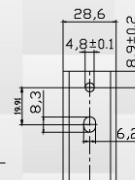

Bike Size: 12" - 14" - 16" - 18" - 20" bicycles.  
Material: 3m/m-3.5m/m steel plate stay.  
Wheel Size: 4-1/2", 5" plastic rim.  
Tire: EVA tire & TPR tire.

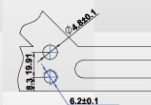

S



SM-801A-LED



SM-216-A



SM-273-A



SM-279-A



SM-280-A



SM-281-A



SM-282-A



SM-284-H



SM-285-A



SM-287-A



SM-540-A



SM-703-A



SM-801-A

Bike Size: 12" · 14" · 16" · 18" · 20" bicycles.  
Material: 3m/m-3.5m/m steel plate stay.  
Wheel Size: 4-1/2", 5" plastic rim.  
Tire: EVA tire & TPR tire.



SM-801-LED



SM-216



SM-273



SM-279



SM-285



SM-287



SM-540



SM-703



SM-280



SM-281



SM-282



SM-284-D



SM-801

Bike Size: 12" · 14" · 16" · 18" · 20" bicycles.  
Material: 3m/m-3.5m/m steel plate stay.  
Wheel Size: 4-1/2", 5" plastic rim.  
Tire: EVA tire & TPR tire.

Packaging style



SM-283-WASP  
16"- 24"



SM-284-WASP  
16"- 24"



SM-701-WASP  
16"- 24"



SM-284-OASP  
12"- 20"



SM-288-OAS  
12"- 20"



Box Packaging  
SM-905  
20"- 29"



Box Packaging  
SM-901-QW  
20"- 26"



Spokey Dokeys  
SM-210-L  
12"- 28"

SM-230

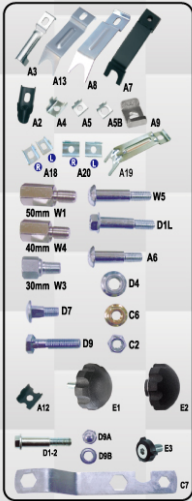

SM-240

The SM-240 items can match any of SM-220 wheels

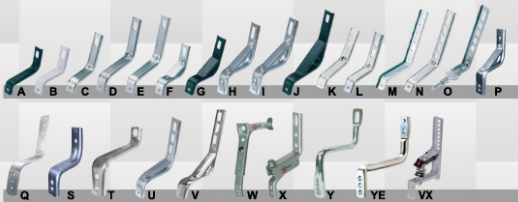

A	10",90°	B	12",90°	C	14",90°	D	16",90°	E	18",90°
F	12",90°	G	14",90°	H	16",90°	I	18",90°	J	20",90°
K	16",45°	L	12"- 14",90°	M	12"- 20",85°	N	12"- 20",85°	O	12"- 20",90°
P	12",90°	Q	12"- 20",85°,5mm	S	12",90°	T	12"- 14",70°	U	12"- 16",90°
V	16"- 20",90°	W	16"- 24",65°	X	12"- 16",90°	Y	12"- 20",90°, 13mm	YE	12",14",16",18",20",90°, 13mm
VX	12"- 20",90°								

SM-220

THE SM-240 ITEMS CAN MATCH ANY OF SM-220 WHEELS.



POP & BIKE